

Warnings and Guidelines

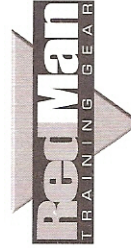

Warnings and Guidelines

LIMITED WARRANTY

Macho/RedMan warrants its products to be free from defects in materials and workmanship for 90 days from the date of purchase, provided the products supplied have not been subject to accident, alteration, negligence, abuse, or misuse. As the sole remedy under this warranty, Macho/RedMan will, at its option, repair or replace non-conforming goods.

TO THE EXTENT ALLOWED BY LOCAL LAW, EXCEPT FOR THE OBLIGATIONS SPECIFICALLY SET FORTH IN THIS WARRANTY STATEMENT, MACHO'S/REDMAN'S LIABILITY AND THAT OF ITS VENDORS OF NEW GOODS SHALL NOT EXCEED THE VALUE OF THE GOODS SOLD. NEITHER MACHO/REDMAN NOR ITS VENDORS SHALL BE LIABLE FOR DIRECT, INDIRECT, SPECIAL, INCIDENTAL, OR CONSEQUENTIAL DAMAGES, WHETHER BASED ON CONTRACT, TORT, OR ANY OTHER LEGAL THEORY.

TO THE EXTENT ALLOWED BY LOCAL LAW, MACHO/REDMAN AND ITS VENDORS DISCLAIM ANY OTHER WARRANTY OF ANY KIND, WHETHER EXPRESS OR IMPLIED WARRANTIES OF MERCHANTABILITY AND FITNESS FOR A PARTICULAR PURPOSE.

10.18.02

CONFIGURATION: D2 HEAD WITH FACE CAGE (sku: HD2C).

READ ALL WARNINGS AND GUIDELINES BEFORE USE. FAILURE TO FOLLOW DIRECTIONS MAY RESULT IN SERIOUS INJURY, DISABILITY, AND DEATH.

INSTRUCTIONS

The D2 Head with Face Cage may be used in place of the Traditional Head with Face Cage in the XP Instructor Suit or the XP Student Suit.

INSTRUCTIONS FOR D2 HEAD AS PART OF THE XP INSTRUCTOR SUIT

The D2 Head with Face Cage is worn by the instructor when the head is not a regular target area, but a margin of protection from **infrequent and accidental light blunt force is desired**. If the instructor's head is a target area for intentional light blunt force, wear the Special Configuration Enhanced Head Assembly.

1. **Attach the D2 Throat Guard** to the D2 Head with Cage before putting on the Headgear. Attach the Throat Guard by pressing the hook on the Throat Guard to the loop on the chin of the D2 Head.
2. **Attach the Face Cage** to the D2 Head before putting on the Headgear. Position the Cage over the face opening of the D2 Head. Wrap the three hook/loop straps through the holes in the Headgear as shown. Press the chin of the Cage to the Headgear to secure hook / loop fastener. Be sure the Cage is snug to the Headgear and does not move on the Headgear.
3. **Put on Safety Glasses** (may also be called Goggles). These are included with all Redman and WDS Headgear.
4. With Safety Glasses on and Throat Guard and Face Cage attached to Head, open the back flaps and pull the D2 Headgear onto head. Fasten the flaps at the back of the head. For correct fit: chin should fit in chin hole, ears should fit in ear openings, and Headgear should fit snugly to the head.

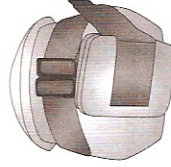
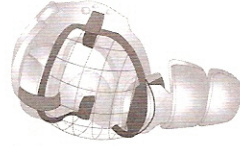

PugilStick.Com

The D2 Head with Cage may be used with the Attachable Shield to allow for training with RedMan Inert OC spray and Soft Practice Knives. See the Redman XP and WDS Product Guide for Warnings and Instruction for Attachable Shield.

INSTRUCTIONS FOR D2 HEAD AS PART OF XP STUDENT SUIT.

The XP Student Suit is the minimum equipment needed for student use in dynamic simulation training without projectiles. Optional gear should be worn at the instructor's discretion, depending on the type of training, the techniques used, and the individual student's physical needs.

The instructor may, for example, choose to omit the Throat Guard from the XP Student Suit. Otherwise, instructions for the D2 Head as part of the Student Suit are the same as for the D2 Head as part of the Instructor Suit.

